

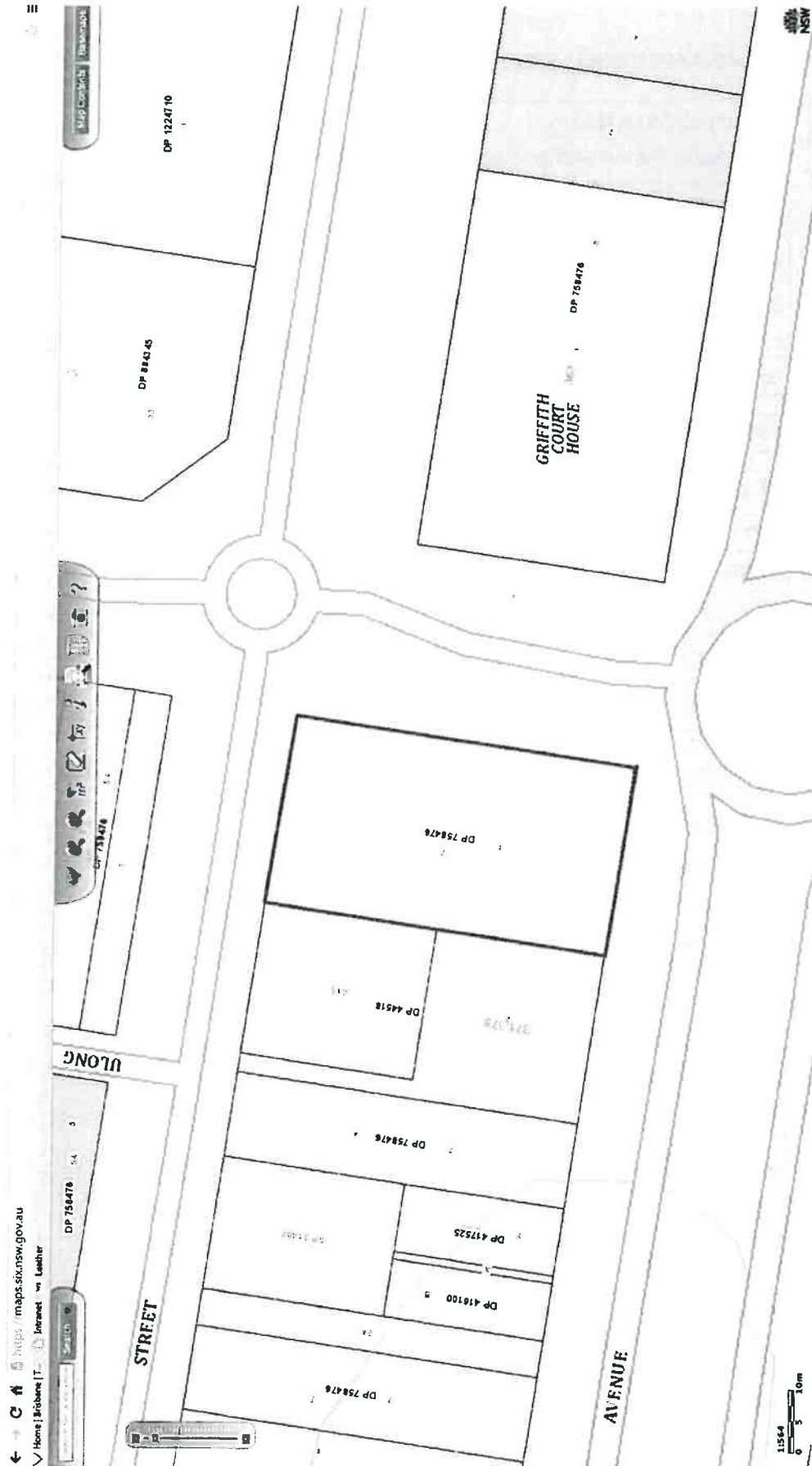

"SCHEDULE B - PART 1"

LPI SIX MAP - DEPICTING LOT 1 IN SECTION 7 IN DP758476



11564
0 5 10m

"SCHEDULE B - PART 2"



Cancels plan Griffith 114.

Town of Griffith

Papers B 34-222

PLAN OF PORTION ALLOT 1 SEC.7
 Parish of Jondaryan County of Cooper
 LAND DISTRICT OF MIRROOL LAND BOARD DISTRICT OF HAY.
 WADE SHIRE

*Standard
 Argent*

Applied for under the Section of the Crown Lands Consolidation Act 1913 by
 Within Town Boundaries of Griffith
 Within the boundaries of Mirrool N^o 1 (Irrigation Area (as varied) Proc. 1st Aug. 1930
 Includes part Public Road R 17672 (as closed by G.S. 10-11-33) R.C. 93-536
 Within the boundaries of Bourke, Cooper, Dowling and Gipps Gold Field Proc. 15th Oct. 1880
 Within Murrumbidgee Northern Irrigation Area
 Within R 1206 from Oesⁿ under M.R. or B.L. noted 14th June 1911.
 Dedicated for Police Purposes G.S. 30-11-34.

PLAN MICROFILMED
 NO ADDITIONS OR AMENDMENTS TO BE MADE

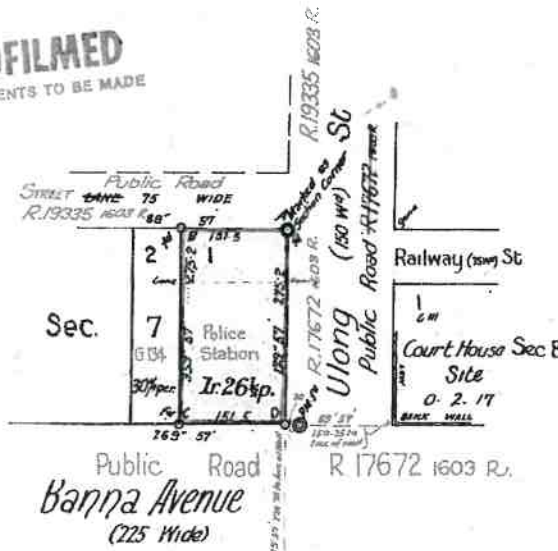

22	21	20	19	18	17
1/2	1/2	1/2	1/2	1/2	1/2
1/2	1/2	1/2	1/2	1/2	1/2

I, Surveyor registered under the Surveyors Act, 1929 do hereby solemnly and sincerely declare that the survey represented in this plan has been made by me in accordance with the Survey Practice Regulations 1933 and the special requirements of the Department of Lands and was completed on the 10th May 1934.
 And I make this solemn declaration conscientiously believing the same to be true and by virtue of the provisions of the Oaths Act, 1900.

Ch Lockwood
 Surveyor registered under the Surveyors Act 1928
 Subscribed and declared before me at Griffith
 this 10th day of May 1934
[Signature]
 Justice of the Peace.

Azimuth taken from B C
 Field Book 33/1 Pages 13

Reference to Corners

Corner	Bearing	From	Stake	N ^o on Plan
A	Numb ^o	Stake		5
B	Numb ^o	Stake		1.2
C	Numb ^o	Stake		1.2
D	Numb ^o	Stake		7
R.M.	269° 57'	Cor. A	5.0	Q.I. Pipe p.p.
R.M.	89° 57'	Cor. D	20.0	(p.a.)

Reference to Traverse

Line	Bearing	Distance

I hereby certify that I in person made and completed the survey represented in this plan on which are written the bearings and lengths of the lines measured by me and I declare that the survey has been made in accordance with the regulations published for the guidance of Licensed Surveyors and in practice of the Department of Lands.

Forwarded to the District Surveyor with my letter of 10th May 34 - 10
 Calculations Book 7^o Folio By Inspection
 Checked and Certified *[Signature]* 29.6.34
 Examined *[Signature]* 29.6.34
 Plan approved *[Signature]*

Improvements

Scale 2 Chains to an Inch

Officer in Charge
 29 June 1934

[Signature] 29/6/34 Cat N^o Griffith 153-2848